

MM250SL - "Muscle MIG" Wire Feed Welder

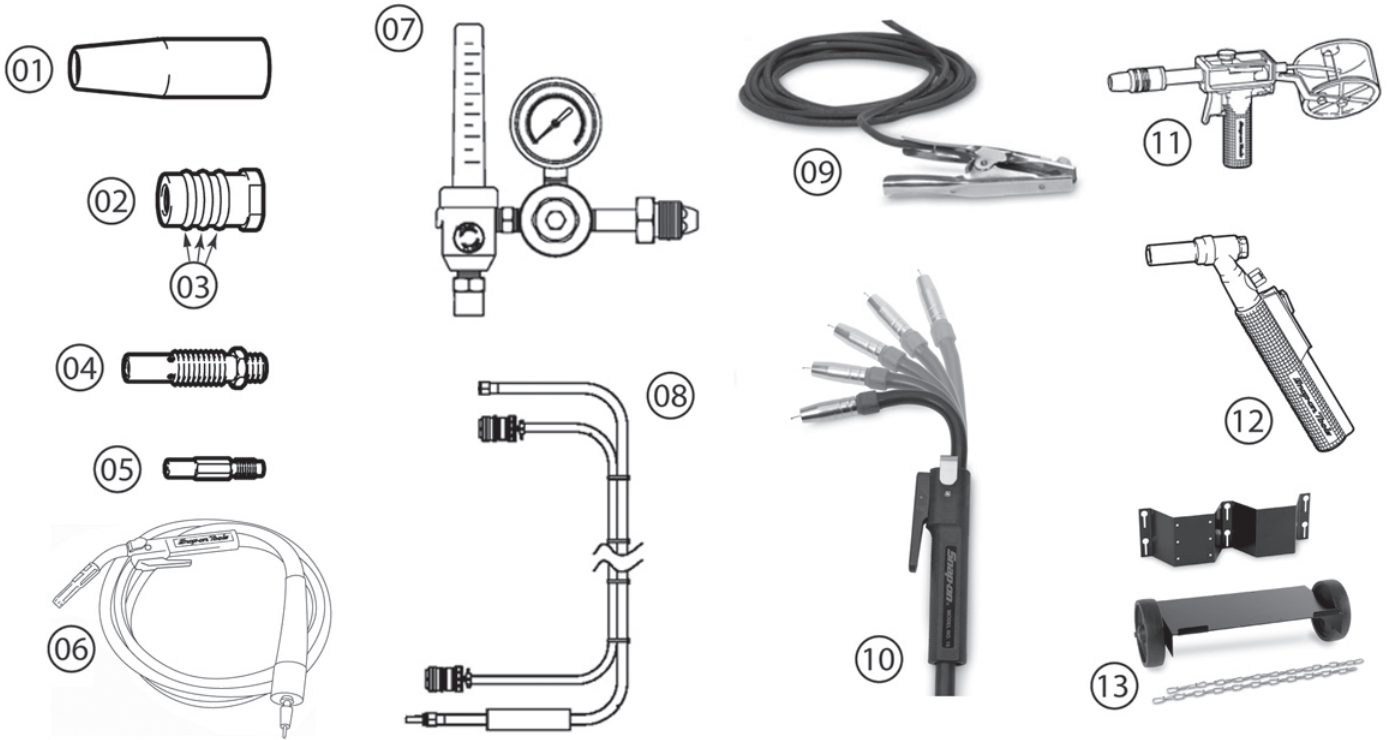

Key	Stock Number	Description
01	CKSM3TN50	1/2" Adjustable Nozzle
02	CKSM3TB2	Insulators (2 ea) and O-Rings (6 ea)
03	CKSM3TBR3	O-Rings for Insulator (3 ea)
04	CKSM3TD	Gas Diffuser
05	CKSM3T3010	Contact Tip - (0.030 wire) 1-7/16" Long (10 ea)
06	CKS15TG1035	10 ft Cable and Torch (0.035 wire)
-	CKSM104LN	Liner for 10 ft Torch (0.030 - 0.035 wire) (not shown)
07	CKSGRFM	Regulator Flowmeter
08	CKSFCA15	Feeder Cable Assembly
09	CKSSN178	15 ft Ground Cable and Clamp
-	CKSM3TNLAS1	Spot Weld Nozzle (not shown)

Optional Replacement Parts and Accessories

Key	Stock Number	Description
10	CKS15FN1030	Flexible Neck Torch
11	MHG5B	Aluminum SpoolGun
12	FLEXTIG25	TIG Conversion Kit with 25' Cable
13	CKS2TK	Twin Cylinder Rack
05	CKSM3T2510	Contact Tip - (0.025 wire) 1-7/16" Long (10 ea)
05	CKSM3T3510	Contact Tip - (0.035 wire) 1-7/16" Long (10 ea)
05	CKSM3T4510	Contact Tip - (0.045 wire) 1-7/16" Long (10 ea)
06	CKS15TG1025	10 ft Cable and Torch (0.025 wire)
06	CKS15TG1030	10 ft Cable and Torch (0.030 wire)
06	CKS15TG1230	12 ft Cable and Torch (0.030 wire)
06	CKS15TG1235	12 ft Cable and Torch (0.035 wire)
06	CKS15TG1535	15 ft Cable and Torch (0.035 wire)
-	CKSM103LB	Liner for 10 ft Torch (0.020-0.030 wire) (not shown)
-	CKSM123LB	Liner for 12 ft Torch (0.020-0.030 wire) (not shown)
-	CKSM124LN	Liner for 12 ft Torch (0.030-0.045 wire) (not shown)
-	CKSM153LB	Liner for 15 ft Torch (0.035 wire) (not shown)



Brand Marketing, Kenosha, WI